

Black Bear Hoist Parts

Phone: 504-616-8789
 Fax: 504-367-9005
 Toll Free: 877-97-HOIST



Parts Pricing and Order Form

Fax , E-Mail or Phone

Company: _____
 Contact: _____
 Phone #: _____
 Fax #: _____
 E-Mail: _____
 Ship To Address: _____

NOTE:

- 1) 1 L. Ft. = 1 Linear Foot
- 2) All prices subject to change without notice.
- 3) All prices in U.S. Dollars - F.O.B. Fontana, California, Prepaid & Add
- 4) Price does not include freight or taxes

Black Bear Hand Chain Hoist - 0.50 Ton (YB-050)

August, 2009

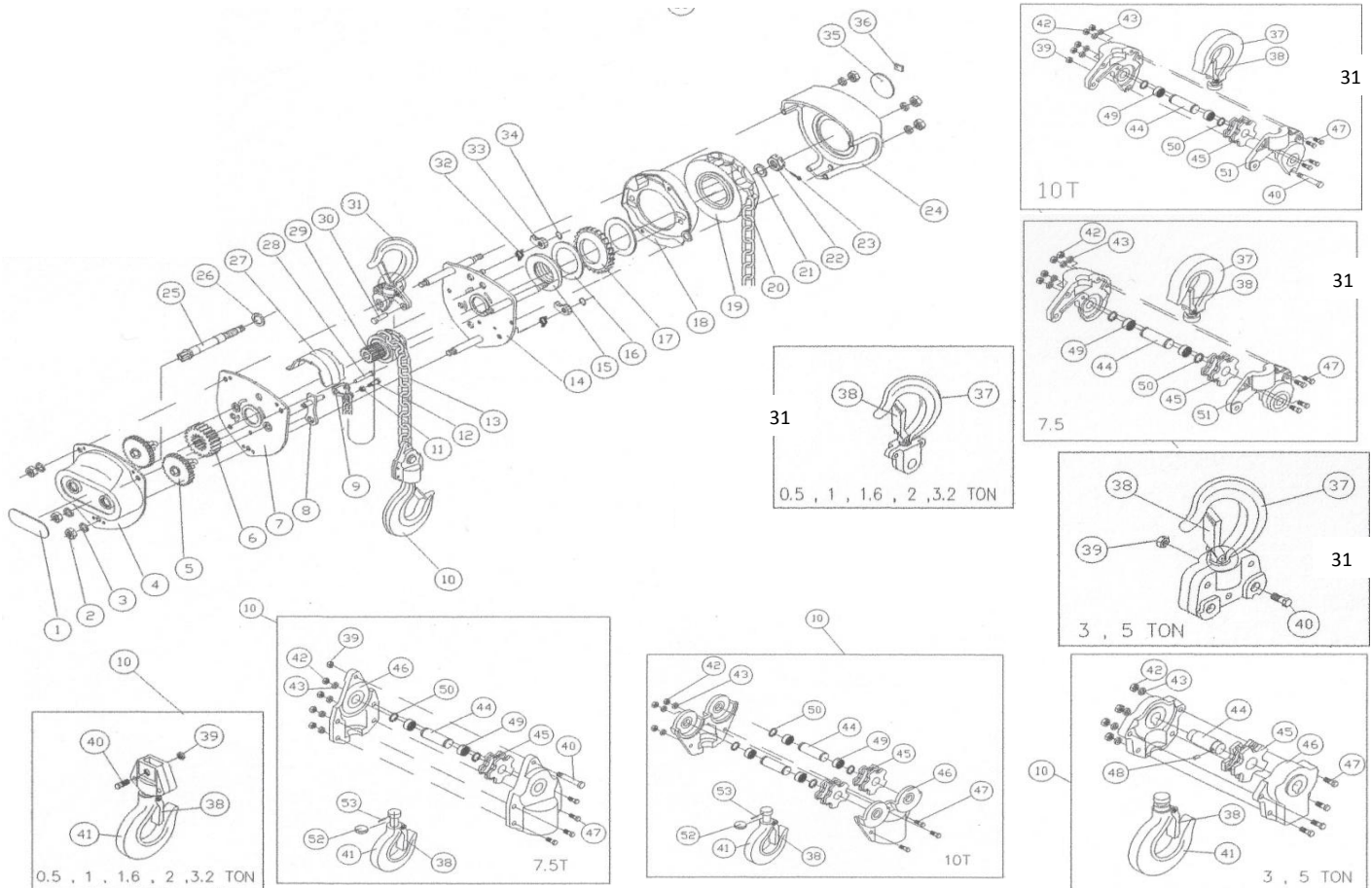

Key No	Part Number	Part Name	Qty Req	Price (each)	Quantity Needed
1	B1903 - 5B37	Name Plate	1	\$1.04	
2	B1421 - 5B43	Hex Nut	6	\$1.04	
3	B1441 - 5B44	Spring Lock Washer	6	\$1.04	

Black Bear Hand Chain Hoist - 0.50 Ton (YB050)

June, 2012

Key No	Part Number	Part Name	Qty Req	Price (each)	Quantity Needed
4	B1201 - 5B26	Gear Cover With Bushings	1	\$13.54	
5	B1202 - 5B25	2nd Gear Assembly	2	\$24.96	
6	B1203 - 5B22	4th. Gear	1	\$15.58	
7	B1204 - 5B17	Gear Side Plate with Bushings	1	\$14.54	
8	B1205 - 5B16	Stripper Assembly	1	\$2.08	
9	B1206 - 5B27	Load Chain Slack End Anchorage	1	\$2.08	
10	B1207 - 5B41	Lower Hook Assembly	1	\$21.83	
11	B1422 - 5B45	Nylon Lock Nut	1	\$1.04	
	B1471 - 5B45	Cutter Pin	2	\$1.04	
12	B1401 - 5B35	Dead End Bolt	1	\$2.08	
	B1208 - 5B28B	Slack End Anchorage Pin	1	\$1.04	
13	B1901 - 5B46	Load Chain (1L. Ft.) 5.0mm*15	1	\$3.23	
14	B1209 - 5B09	Brake Side Plate with Bushings	1	\$19.75	
15	B1210 - 5B06	Hub	1	\$7.29	
16	B1211 - 5B04	Friction Washer	2	\$2.08	
17	B1212 - 5B05	Ratchet	1	\$8.33	
18	B1213 - 5B03	Ratchet Cover	1	\$6.25	
19	B1214 - 5B02	Hand Wheel	1	\$19.75	
20	B1902 - 5B38	Hand Chain (1L. Ft.) 5.0mm* 23.5	1	\$3.25	
21	B1442 - 5B34	Flat Washer	1	\$1.04	
22	B1423 - 5B48	Castle Nut	1	\$1.04	
23	B1472 - 5B49	Cutter Pin	1	\$1.04	
24	B1215 - 5B01	Hand Wheel Cover	1	\$13.50	
25	B1216 - 5B21	1st. Gear	1	\$14.54	
26	B1217 - 5B23	Flat Washer	1	\$1.04	
27	B1218 - 5B12	Chain Guide	1	\$2.08	
28	B1219 - 5B28A	Slack End Anchorage Pin	1	\$1.04	
29	B1220 - 5B14	Load Sheave	1	\$19.71	
30	B1221 - 5B11	Upper Hook Pin	1	\$1.04	
31	B1222 - 5B42	Upper Hook Assembly	1	\$20.79	
32	B1223 10B08	Pawl Spring	2	\$1.04	
33	B1224 - 10B07	Pawl	2	\$5.21	
34	B1461 - 10B47	Snap Ring	2	\$1.04	
35	B1904 - 5B57	Warning Label	1	\$5.25	
36	B1905 - 5B58	Class Label	1	\$2.08	
37	B1225 - 5B31A	Top Hook	1	\$11.46	
38	B1226 - 5BVIII	Safety Latch Assembly	1	\$5.25	
39	B1424 - 5B55	Nylon Lock Nut	1	\$1.04	
40	B1402 5B35	Dead End Bolt	1	\$1.04	
41	B1227 - 5B31A	Bottom Hook	1	\$11.46	
42	B1425	Hex Nut	4/7/8	Not Used	
43	B1443	Spring Lock Washer	4/7/8	Not Used	
44	B1228	Sheave Shafe	1/2/3	Not Used	
45	B1229	Sheave Wheel	1/2/3	Not Used	

